

S.W.R. uPVC

Soil, Waste and Rainwater Drainage System

... Most comprehensive range with wide spectrum of fittings

The Supreme Industries Ltd., is an acknowledged leader of India's plastic industry. It is credited with pioneering several path breaking products and has valuable experience in providing innovative and cost effective piping solution. Company's objective is to meet the growing needs of its clientele in water, waste management and infrastructure sector through specially developed high performance range of piping products. The innovative product portfolio offered by Supreme is extensive in range and application and comprises a variety of pipes and a vast spectrum of fittings totaling around 7000 diverse products. Together these constitute the most comprehensive range in the industry that caters almost every conceivable need and application. Company has been a torch bearer in transition from conventional products to advance plastics piping products in the country and has been termed as "Trend Setters of Plastic Piping Products".

The S.W.R. Drainage System is the result of Supreme's pioneering research, and was the first such PVC system in India, which has successfully replaced CI and AC products. It enables fast and efficient removal of waste without blockage and leakage. Its high impact strength, chemical and corrosion resistance, long life and virtually zero maintenance explains, why it continues to be the preferred brand of architects and builders everywhere.



IS :13592

CML :7158777

IS :14735

CML:7351569



The System

Supreme S.W.R. drainage system is designed for quick and efficient removal of waste without leakage. It is highly resilient, tough and durable with high tensile and impact strength. Moreover it is free from scale formation, rusting, weathering and chemical action. It is virtually immune to attack by bacteria, fungi, micro-organisms and insects. Thus the system is a long term solution for building drainage with estimated life over 50 years. In addition to the various benefits, it is more cost effective than any conventional drainage system. It is approved by MCGM and widely used by millions of quality conscious customers.

Product Specifications and Range

Pipes are available in 75, 90, 110 and 160 mm and fittings are available in 40 to 160 mm sizes. Pipes conforms to IS 13592:92 and fittings conforms to IS 14735:99 and are made as per international standards. Supreme S.W.R. drainage system is available in

- Rubber ring type joints
- Fix 'O' ring type seal design
- Pasted type joints (solvent weld)

Features and benefits

High quality standards and wide range - The system consists of pipes and a wide range of fittings with various traps, which makes the system complete in all respect.

Stronger and longer lasting - This system is highly resilient, tough and durable with high tensile strength and high impact strength. Moreover it is free from problems caused by scale formation, rusting, weathering and chemical action and hence lasts for lifetime.

Excellent chemical and corrosion resistance - Being non-metallic, this system is completely free from corrosion and offers very good resistance to wide range of chemicals.

UV resistance - which eliminates the adverse effect of sunlight and weather, hence can be safely used for outdoor installations.

Quick and convenient installation - Being extremely light in weight and provided with special rubber jointing technique, installation of this system becomes much easier.

Quick and efficient removal of waste without leakage - Mirror smooth and restriction free inner surface of pipes and fittings ensures superior flow characteristics, thus the system is free from problems of clogging and drain choke-up. System is completely leak-proof and designed to maintain high standards of hygiene.

Adequate and easy access for cleaning and clearing obstructions.

Least maintenance - Once installed Supreme S.W.R. drainage system needs minimal maintenance.

Cost effective - Supreme S.W.R. drainage system is more cost effective than any conventional drainage system.

Fittings



Swept Tee with door



Reducing Tee



Reducing Tee with Door



Reducing Cross Tee with Door



Door Bend 87.5° (TS)



Bend 45°



Reverse Y



Double Y



Double Y with Door



Flexi W.C. Connector / Adapter



W.C. Connector (Bend)



W.C. Connector

Different Traps



Nahani Trap



Nahani Trap Premium



Nahani Trap (One Piece)



Wash Basin 'P' Trap



Kitchen Line Trap



'P' Trap



Coupler



Repair Coupler



Connecting Coupler



Single Tee



Single Tee with door



Swept Tee



Reducing Swept Tee



Reducing Swept Tee with Door



Bend 87.5°



Eccentric Reducer



Cross Tee



Cross Tee with Door



Long Swept Bend 87.5°



Variable Bend (0-30°)



Door Bend (RS/LS)



Cleaning Pipe



Single Y



Single Y with Door (LH/RH)



Reducing Y



Reducing Double Y



Reducing Double Y with Door



Vent cowl Premium

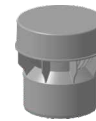

Air Admittance Valve



W.C. Connector straight (Reducer type)



W.C. Manifold



Floor Drain (B)



Extended Balcony Drain



Shower Drain Channel



Dom Roof Outlet



Roof Corner Outlet



Flush Valve



Plain Floor Traps



Multi Floor Traps



Sunken Multi Floor Trap



Height Riser



Extension Piece (with S.S. grating cover)



U-Trap



'Q' Trap



'S' Trap



Gully Trap



Bell Mouth Trap



Square Gully Trap

Dimensions of Pipes

Nominal outside diameter (D) mm	Tolerance on outside diameter mm	Wall Thickness-Type-A (t) mm		Wall Thickness-Type-B (t) mm		Wall Thickness-Suffia (Non-standard) (t) mm	
		Min.	Max.	Min.	Max.	Min.	Max.
75	+0.3	1.8	2.2	3.2	3.8	1.4	1.6
90	+0.4	1.9	2.3	3.2	3.8	-	-
110	+0.4	2.2	2.7	3.2	3.8	1.5	1.65
160	+0.5	3.2	3.8	4.0	4.6	2.7	3.2

NOTE: As per IS 13592-1992 **TYPE A** pipes are recommended for use in ventilation pipe work and rain water application and **TYPE B** pipes are recommended for use in soil and waste discharge system. Pipes are available in 2, 3, 4, 6 and 10 feet lengths in single and double sockets in all sizes.



Joining Instructions

- Make sure the spigot end and inside of socket is clean and the sealing ring is placed evenly in the socket.
- When cutting pipes, make sure they are cut square. Cut end of pipes should be deburred and chamfered to an angle of 15° with a medium file. This is important to avoid displacement of the rubber ring.
- A correct depth of entry of the spigot into the socket is required to allow thermal movement. To achieve this, push spigot fully into the socket (remove sealing ring at this time) and make a mark on the spigot. Withdraw the spigot by 10 mm and mark the spigot with bold line. This bold mark indicates the correct depth of entry to allow the necessary expansion gap.
- Apply Supreme rubber lubricant evenly on the pipe or fitting spigot and the sealing ring. Then insert the spigot into socket with light twisting motion. Pull out the pipe to allow 10 mm expansion gap.
- The joint is now complete and required no additional mastics, tape, cement or any other joining sealants.

Consumption of Rubber Lubricant

Size in mm	75	110	160
No. of joints / kg.	500	300	200

Maximum Support Distance in Meters

Size in mm	75	90	110	160
Horizontal	0.75	0.9	1.1	1.6
Vertical	2.00	2.00	2.00	2.00

Important Information

- Only UV stabilized uPVC SWR pipes with rubber ring / click ring or pasted type only should be used. The regular uPVC pressure pipes with solvent cement jointing when exposed to sun-rays / weather get brittle and brownish and joint get opened due to thermal expansion.
- Use only rubber lubricant for joining SWR pipes and fittings where rubber ring is used.
- Avoid over tightening of door caps. Proper placement of rubber ring should be confirmed before tightening.
- Avoid misalignment of vertical SWR pipe stacks and incorrect spacing of pipe clips.
- Use of rubber ring type joint for horizontal installation requires proper supports and alignment and hence pasted type joint should be preferred.
- Cutting of pipes should be straight, as diagonal cutting may lead to leakage.
- All entry to main stacks should be protected with water seal trap, wherever there is mixing of Soil and Waste lines.
- Keep a gap of 10 mm between all pipes and fittings to accommodate thermal expansion and contraction of pipes for longer life of the system.
- Smoke test should be avoided and test plug/socket plug should be used for testing the lines.
- Horizontal lines within bathrooms should be cement encased and tested before compacting of sunken floor to avoid any accidental damages.
- For further technical information/assistance, the manufacturer to be contacted for required clarification.

• All the dimensions unless otherwise specified are in mm • All information contained in this literature is given in good faith and believed to be accurate and reliable. But because of many factors which are outside our knowledge and control and affect the use of product, no warranty is given or is to be implied with respect to such information, nor we offer any warranty of immunity against patent infringement. No responsibility can be accepted for any error, omissions or incorrect assumptions. • Any specifications can change without prior notice.

The Supreme Industries Ltd. (Plastic Piping Division)

Corporate Office : 1161/1162, Solitaire Corporate Park, Building No. 11,167, Guru Hargovindji Marg, Chakala, Andheri Ghatkopar Link Road, Andheri (East) Mumbai - 400 093. India. Tel: 91-22-67710000, 40430000 Fax: 67710099 /40430099.

Regd. Office : 612 Raheja Chambers, Nariman Point, Mumbai 400 021. India Tel.: (022) 22851656, 22820072 Fax : (91-22) 22851657

E-mail: pvc-pipes@supreme.co.in **Website :** www.supreme.co.in

Works : • D-101/102, MIDC, Jalgaon - 425 003.

• Unit No.3, Gat No.47-48, at post Gadegaon, Tal. Jamner ,Dist., Jalgaon- 425 114

Export Division : 91-22-6771 0126 / 4043 0126 Fax : 6771 0130

Overseas Office : Sharjah, U.A.E. Tel # + 971 6 557 4484; Fax # + 971 6 557 4485

CIN: L35920MH1942PLC003554

Branch Offices ☎ Tel.

Ahmedabad	: 079-30028371	27680064
Bangalore	: 080-30913715	22104697
Chennai	: 044-39811181	43850498
Cochin	: 0484-2385346	2385345
Hyderabad	: 040-23261150	23261120
Indore	: 0731-2432684	2432684
Jaipur	: 09910995853	-
Jalgaon Gadegaon	: 0257-3050541, 42	3050611
Kanpur	: 0512-2332276	2332276
Kolkata	: 033-30070123	24858838
Noida (Delhi)	: 0120-6660000	-

☎ Fax

Authorised Distributor



I & T SIL Gadegaon, Dist-Jalgaon • PC/SWR-MP/MKG/68 • REV.05-12/2016